



PERCY CIRCUS, LONDON, WC1X
£795,000 LEASEHOLD 977 YEARS

**THE FLAT IS IMPECCABLY FINISHED THROUGHOUT
AND HAS COPIOUS AMOUNTS OF STORAGE SPACE.**

Clerkenwell | 020 7405 1288 | clerkenwell@winkworth.co.uk

Winkworth

for every step...

winkworth.co.uk

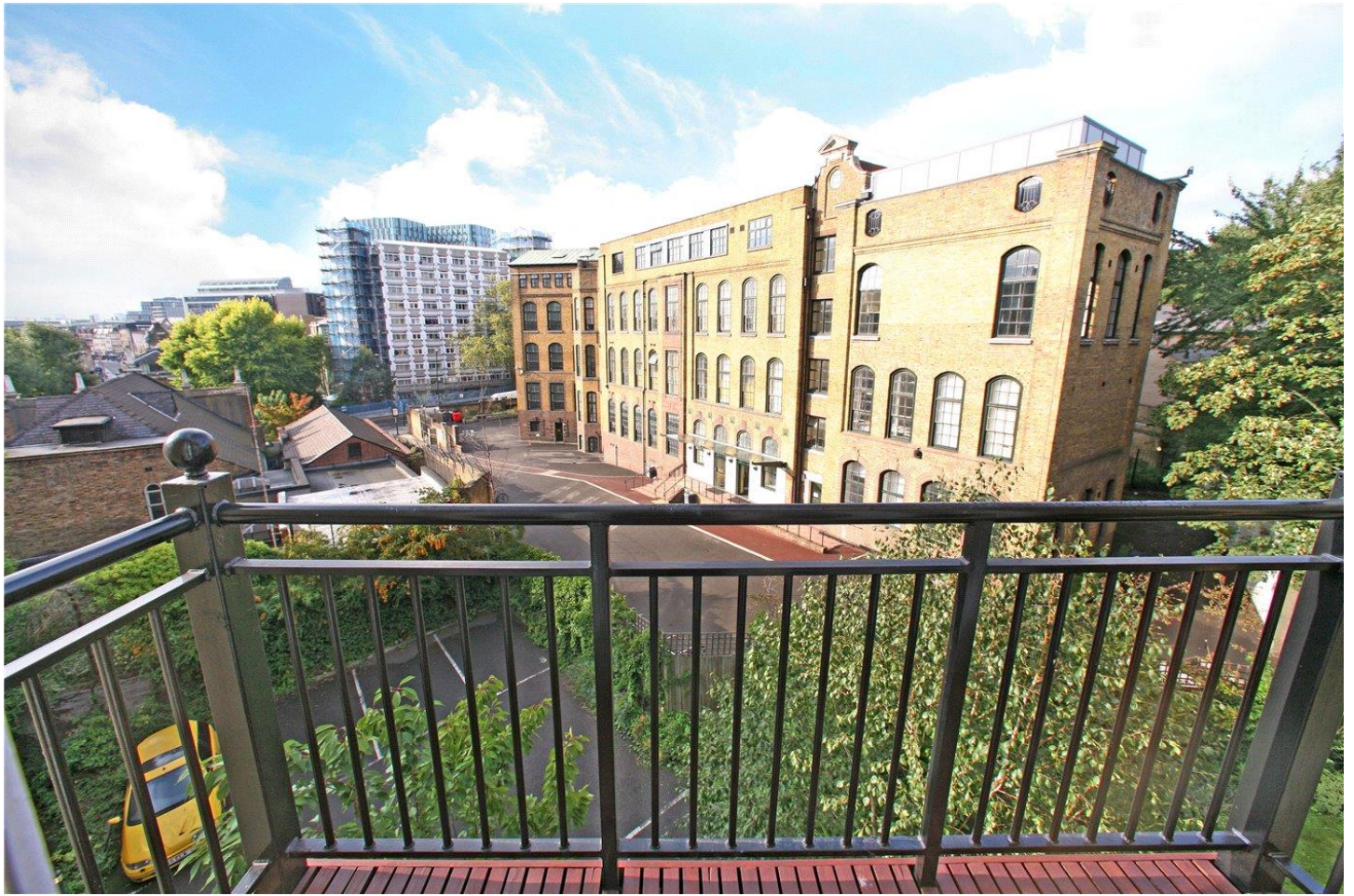

DESCRIPTION:

Additionally the flat has a balcony off the reception room that overlooks the communal gardens. Percy Circus is ideally located close to local shops and amenities on Amwell Street with Kings Cross Station also a short walk away.

Service Charge- £2,200 P/A | Ground Rent- £200 P/A



Winkworth

for every step...



Winkworth

for every step...

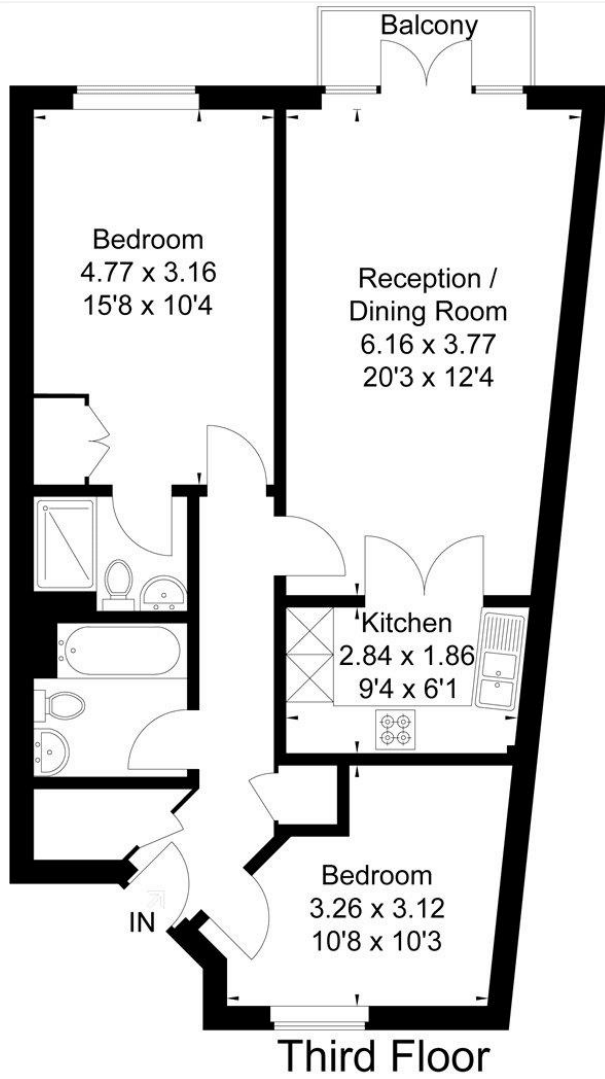

Percy Circus, WC1X

Approximate Gross Internal Area
69 sq m / 743 sq ft



Floorplan © 2014
0845 6344080 Ref: 133996

This plan is for layout guidance only.
Drawn in accordance with RICS guidelines. Not drawn to scale, unless stated. Windows & door openings are approximate. Whilst every care is taken in the preparation of this plan, please check all dimensions, shapes & compass bearings before making any decisions reliant upon them.

Third Floor

This floorplan is for illustration purposes only and is not to scale. The position and size of doors, windows, appliances and other features are approximate.

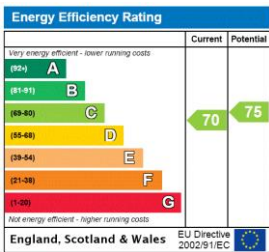

Clerkenwell | 020 7405 1288 | clerkenwell@winkworth.co.uk



for every step...

winkworth.co.uk

Winkworth wishes to inform prospective buyers and tenants that these particulars are a guide and act as information only. All our details are given in good faith and believed to be correct at the time of printing but they don't form part of an offer or contract. No Winkworth employee has authority to make or give any representation or warranty in relation to this property. All fixtures and fittings, whether fitted or not are deemed removable by the vendor unless stated otherwise and room sizes are measured between internal wall surfaces, including furnishings.