



GLOBE ROAD, LONDON, E2
£1,100,000 FREEHOLD

AN EXQUISITE FOUR/FIVE BEDROOM EDWARDIAN HOUSE SET ON GLOBE ROAD

Shoreditch | 020 7749 7650 | shoreditch@winkworth.co.uk

Winkworth

winkworth.co.uk

See things differently



DESCRIPTION:

This truly wonderful four/five-bedroom Edwardian house offers well-proportioned, and light filled rooms over two floors and spans almost 1200sqft. The ground floor is currently set with two double bedrooms to the front of the property, however, provides a perfect entertaining layout with living room located to the front and sizable contemporary kitchen found to the rear where access is provided to a conservatory and private rear garden. Three double bedrooms are located on the first floor, all benefitting from inbuilt storage along with a modern family bathroom. The property is completed with a downstairs additional bathroom and is offered to the market on a chain free basis.

Globe Road is an ideal location with an array of local amenities on Bethnal Green Road as well the boutique shops, cafes, bars and restaurants on Shoreditch close by. Nestled just moments from Bethnal Green underground station and the open green spaces of Victoria Park, this a fantastic location for professionals and young families.

Winkworth



Winkworth

Globe Road , E2

Approx. Gross Internal Floor Area 1176 sq. ft / 109.27 sq. m

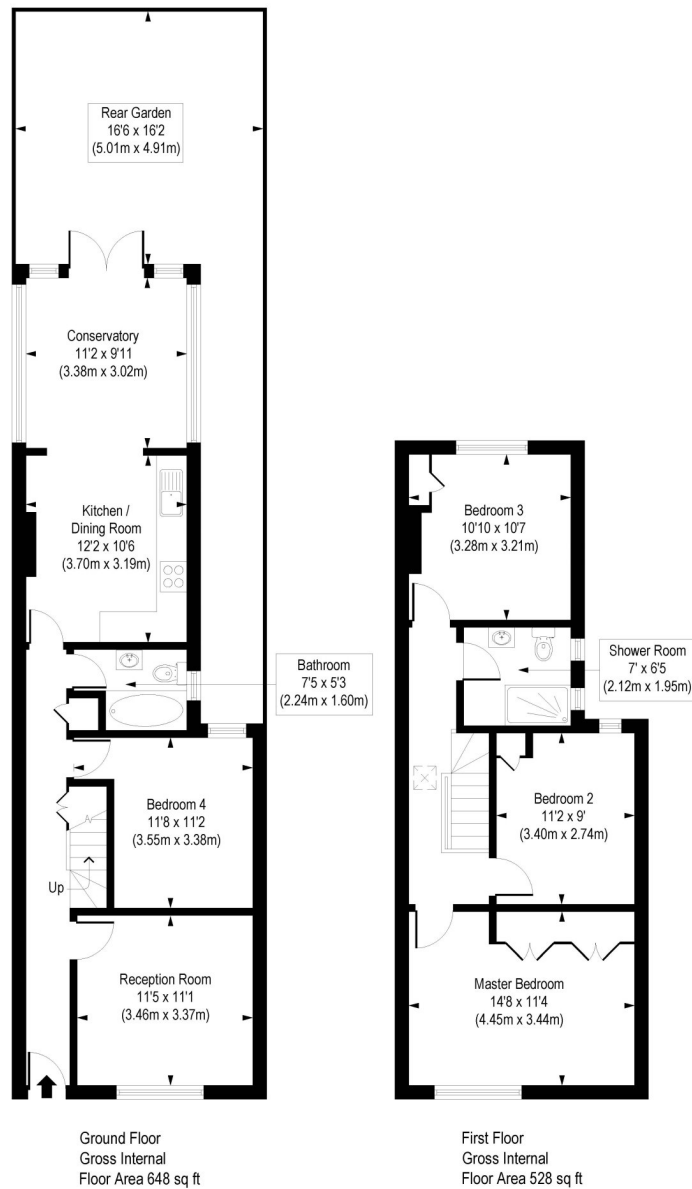

COMPLIANT WITH RICS CODE OF MEASURING PRACTICE. Floorplan is for illustrative purposes only and is not to scale. Every attempt has been made to ensure the accuracy of the floorplan shown, however all measurements, fixtures, fittings and data shown are an approximate interpretation for illustrative purposes only. Liability for errors, omissions or mis-statement through negligence or otherwise is hereby excluded.

This floorplan is for illustration purposes only and is not to scale. The position and size of doors, windows, appliances and other features are approximate.

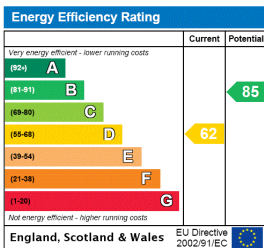

Shoreditch | 020 7749 7650 | shoreditch@winkworth.co.uk



winkworth.co.uk

See things differently

Winkworth wishes to inform prospective buyers and tenants that these particulars are a guide and act as information only. All our details are given in good faith and believed to be correct at the time of printing but they don't form part of an offer or contract. No Winkworth employee has authority to make or give any representation or warranty in relation to this property. All fixtures and fittings, whether fitted or not are deemed removable by the vendor unless stated otherwise and room sizes are measured between internal wall surfaces, including furnishings.