



LEESIDE CRESCENT, NW11
£1,150,000 FREEHOLD

Located in a highly desirable residential street

**5 Bedrooms/ Guest WC/ 3 Reception Rooms/ 2 Bathrooms/
Approx 55' South Facing Garden/ Further Potential/ Chain Free/
EPC Rating: D**



DESCRIPTION:

An excellent opportunity to buy this spacious five bedroom 2 bathroom family home with great further potential if required.

Leaside Crescent is located within a short distance of Golders Green and all shopping facilities at Temple Fortune. Accommodation comprises on the ground floor 2 interconnecting reception rooms, a breakfast room and fitted kitchen. There is also a guest WC. On the 1st floor there are 3 bedrooms plus a bathroom and separate WC. A further staircase up to the converted loft where there are 2 additional bedrooms and a shower room.

The property is offered chain free and is ready for immediate occupation. If required (subject to planning) it would be possible to enlarge the ground floor area to create a large family/kitchen space that would greatly enhance the house’s benefits.

Early viewing is strongly recommended.

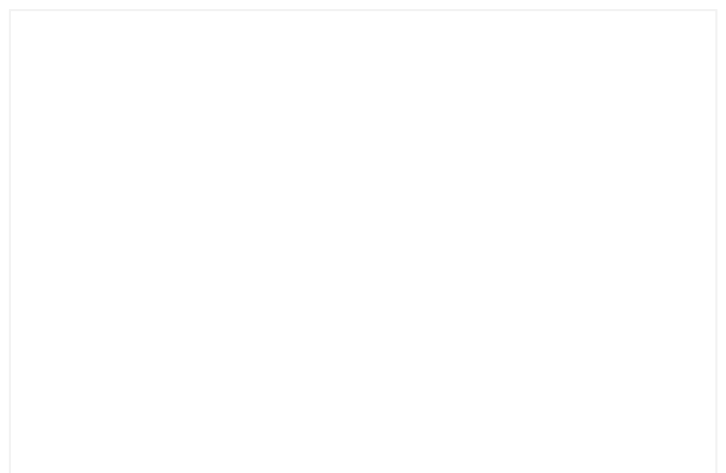
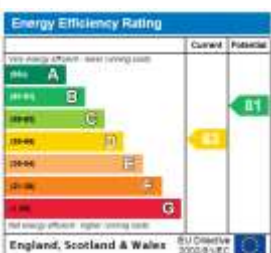



5 BEDROOM SEMI-DETACHED HOUSE, LEESIDE CRESCENT, LONDON, NW11

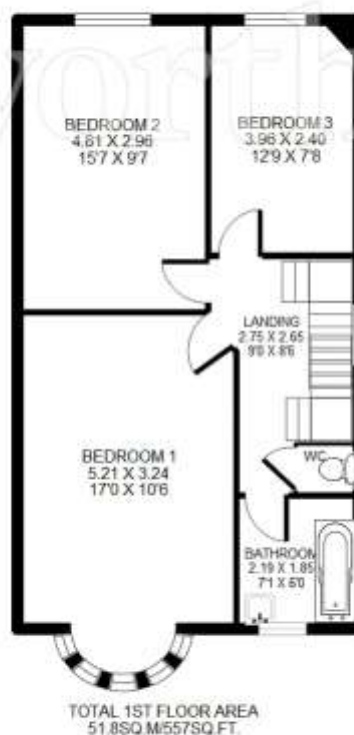

TOTAL APPROX INTERNAL FLOOR AREA 142.45SQM/1532SQFT.
 THIS FLOOR PLAN IS FOR ILLUSTRATIVE PURPOSES ONLY
 AND SHOULD BE USED FOR THIS PURPOSE BY
 PROSPECTIVE APPLICANTS AS ITS NOT TO SCALE.