



HAWFINCH HOUSE, WEST HENDON, LONDON, NW9
£450,000 LEASEHOLD

**A BRIGHT AND SPACIOUS TWO BEDROOM
TWENTIETH FLOOR APARTMENT (WITH LIFT)
IN A PRIME LOCATION IN WEST HENDON**

Hendon | 020 8202 1031 | hendon@winkworth.co.uk

Winkworth

for every step...

winkworth.co.uk



DESCRIPTION:

This is a bright and spacious two bedroom twentieth floor apartment (with lift) in a prime location in West Hendon. Living accommodation extends to c. 773 sq. ft. and comprises a luxury fitted kitchen with integrated appliances, reception area leading to a large private balcony, master bedroom with en-suite shower room, generous size second bedroom, together with a family bathroom.

The development is conveniently located, being close to transport links and the local amenities the area has to offer.

Hendon Waterside is a flagship regeneration development and an impressive Site of Scientific Interest, which is helping to transform the local area's landscape. The development overlooks the Welsh Harp Reservoir and is conveniently placed for an easy commute into central London.

Viewing is highly recommended.

EPC: B

AT A GLANCE

- STUNNING TWO BEDROOM TWENTIETH FLOOR APARTMENT
- GREAT SIZE AT 773 SQ FT
- PRIVATE BALCONY WITH FANTASTIC VIEWS PLUS ACCESS TO COMMUNAL TERRACE
- LONG LEASE
- FANTASTIC LOCATION WELL SUITED FOR TRANSPORT INTO CENTRAL LONDON





Hawfinch House

Approx. Gross Internal Area = 71.9 sq m / 773 sq ft

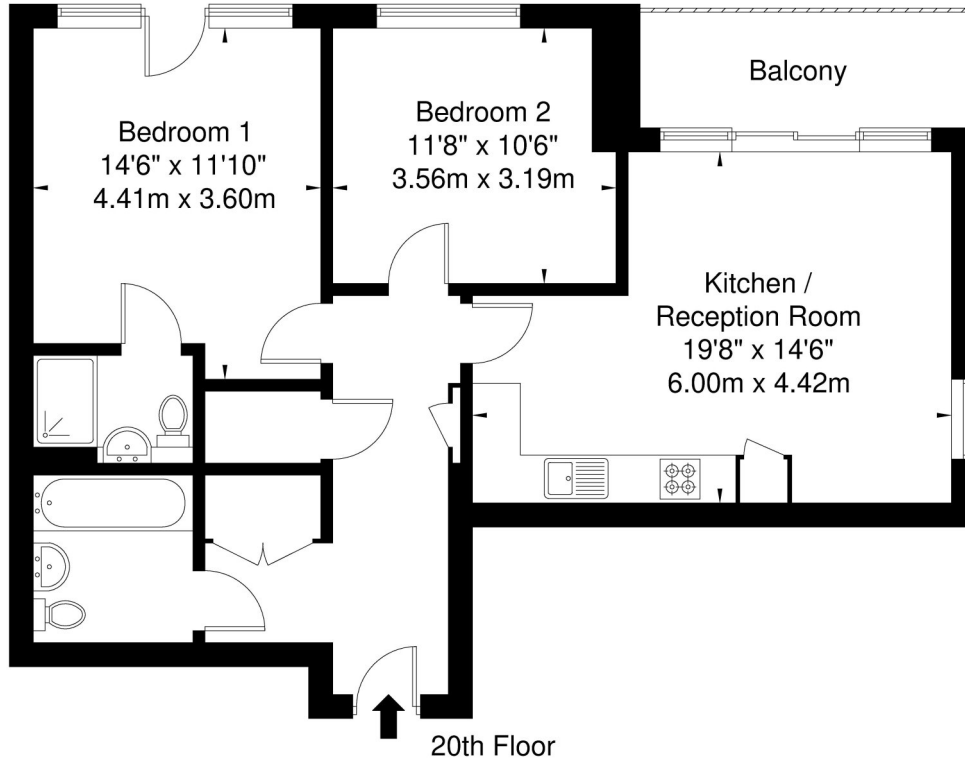

Ref

Copyright

**BLEU
PLAN**

The Floor plan is not to scale and measurements and areas shown are approximate and therefore should be used for illustrative purposes only. The plan has been prepared in accordance with the RICS code of Measuring Practice and whilst we have confidence in the information produced it must not be relied on. If there is any aspect of particular importance, you should carry out or commission your own inspection of the property.

Copyright @ BLEUPLAN

This floorplan is for illustration purposes only and is not to scale. The position and size of doors, windows, appliances and other features are approximate.

Energy Efficiency Rating		Current	Potential
Very energy efficient - lower running costs	A		
(92+)	B	84	84
(81-91)	C		
(69-80)	D		
(55-68)	E		
(39-54)	F		
(21-38)	G		
Not energy efficient - higher running costs			
England, Scotland & Wales		EU Directive 2002/91/EC	



Hendon | 020 8202 1031 | hendon@winkworth.co.uk

for every step...

winkworth.co.uk

Winkworth wishes to inform prospective buyers and tenants that these particulars are a guide and act as information only. All our details are given in good faith and believed to be correct at the time of printing but they don't form part of an offer or contract. No Winkworth employee has authority to make or give any representation or warranty in relation to this property. All fixtures and fittings, whether fitted or not are deemed removable by the vendor unless stated otherwise and room sizes are measured between internal wall surfaces, including furnishings.