



LEE PARK, BLACKHEATH, LONDON, SE3 9HE
GUIDE PRICE £700,000-£735,000

SPANNING OVER 1,000 SQ.FT AND LOCATED ON THIS SOUGHT AFTER ROAD JUST MOMENTS FROM BLACKHEATH VILLAGE AND STATION, IS THIS SPACIOUS TWO DOUBLE BEDROOM APARTMENT WITH AN ADDITIONAL STUDY, OCCUPYING THE ENTIRE FIRST FLOOR OF THIS IMPRESSIVE DETACHED VICTORIAN HOUSE.

Blackheath | 0208 8520999 | blackheath@winkworth.co.uk

Winkworth

winkworth.co.uk

See things differently



DESCRIPTION:

The property is in reasonable condition with scope to enhance. Features include high ceilings, sash windows and gas fired central heating.

The accommodation comprises; a huge (22'1x16'2) reception/dining room which leads onto a separate kitchen. There are two large double bedrooms, a separate study or cot room and a large bathroom. There is also an extra room just outside the entrance to the property which is used as storeroom but has plumbing and work as an excellent utility room. Additional benefits include ample off street parking for multiple cars, a communal garden and is sold chain free.

We anticipate the property to be extremely popular so your earliest viewing is highly recommended. Video tour can be seen at winkworth.co.uk.

The property sits on the leafy Lee Park, SE3 and is located very close to Blackheath Village with its array of boutiques, bars, restaurants and station. Manor House gardens, Lee, Hither Green, Lewisham stations and just a short walk. Travel times to London Bridge are 7 minutes from Lewisham Station and there is access to Canary Wharf, via DLR, London Canon Street, Charing Cross, Waterloo East and Victoria. Local shops and amenities including Sainsbury's and Marks and Spencer's food, are within a very short walk.

The popular open spaces of Blackheath Common, (0.4 miles), Greenwich Park, (0.8 miles), and Manor House Gardens, (0.4 miles), are all within a short walk.





First Floor

Approx. 99.4 sq. metres (1069.6 sq. feet)

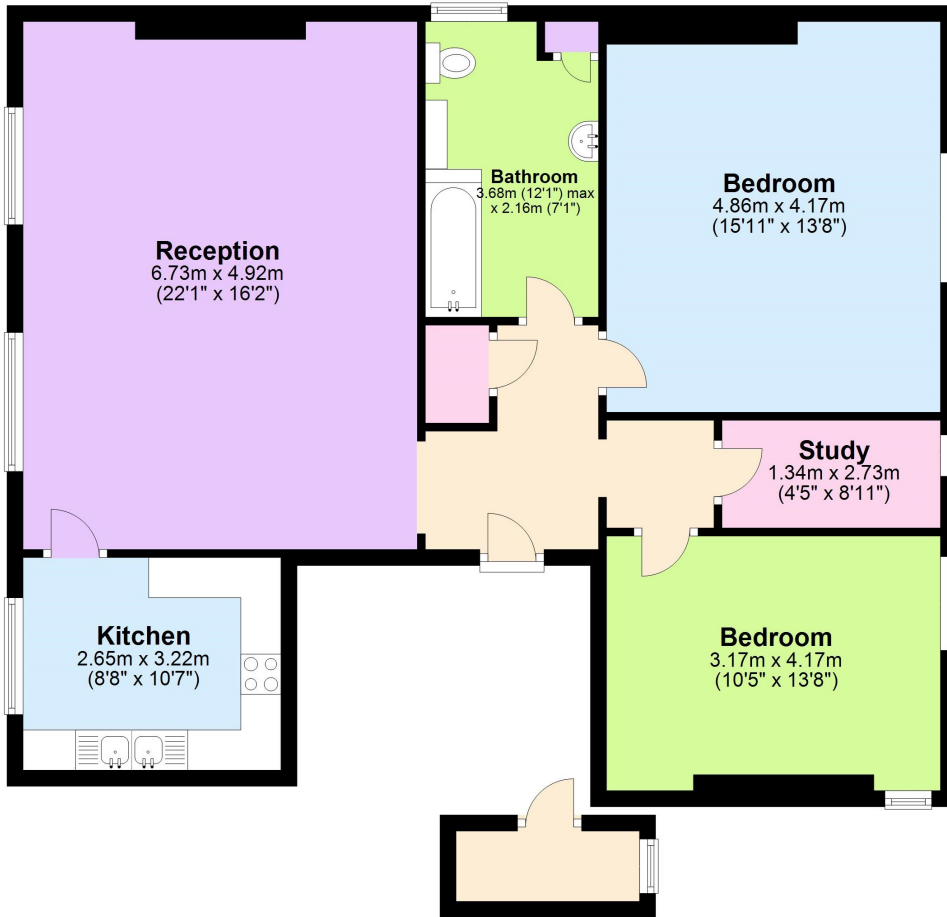

Total area: approx. 99.4 sq. metres (1069.6 sq. feet)

This floorplan is for illustration purposes only and is not to scale. The position and size of doors, windows, appliances and other features are approximate.

Blackheath | 0208 8520999 | blackheath@winkworth.co.uk

Winkworth

winkworth.co.uk

See things differently

Winkworth wishes to inform prospective buyers and tenants that these particulars are a guide and act as information only. All our details are given in good faith and believed to be correct at the time of printing but they don't form part of an offer or contract. No Winkworth employee has authority to make or give any representation or warranty in relation to this property. All fixtures and fittings, whether fitted or not are deemed removable by the vendor unless stated otherwise and room sizes are measured between internal wall surfaces, including furnishings.