



CRANFIELD HOUSE, SOUTHAMPTON ROW, LONDON, WC1B
£900,000 LEASEHOLD

A TWO BEDROOM, FIRST FLOOR FLAT SET IN A 1960'S PURPOSE BUILT RED BRICK MANSION BLOCK WITH ACCESS TO COMMUNAL GARDENS AND FACING THE REAR SO THEREFORE IS VERY QUIET.

TENURE: Leasehold

LEASE TERM: 109 Years remaining

GROUND RENT SERVICE/MAINTENANCE CHARGE: with a peppercorn ground rent and a service charge currently of £1,888.03 per quarter, which includes building up reserves against future S20 costs that would otherwise be incurred by lump sum.

Council tax Band F PAYABLE 2589.

West End | 020 7240 3322 | westend@winkworth.co.uk

Winkworth

for every step...

winkworth.co.uk



DESCRIPTION:

The property has a balcony overlooking the communal gardens, a large lounge, two bedrooms, one bathroom and a separate WC with wash hand basin. The building is also portered. The Flat is set in a good location being within walking distance of LSE, UCL and Kings. Russell Square and Holborn tube stations are nearby, as is the Brunswick Centre. Both Covent Garden and Soho are on your doorstep with its world-famous theatres and restaurants.



Winkworth

for every step...



Winkworth

for every step...

Southampton Row, WC1

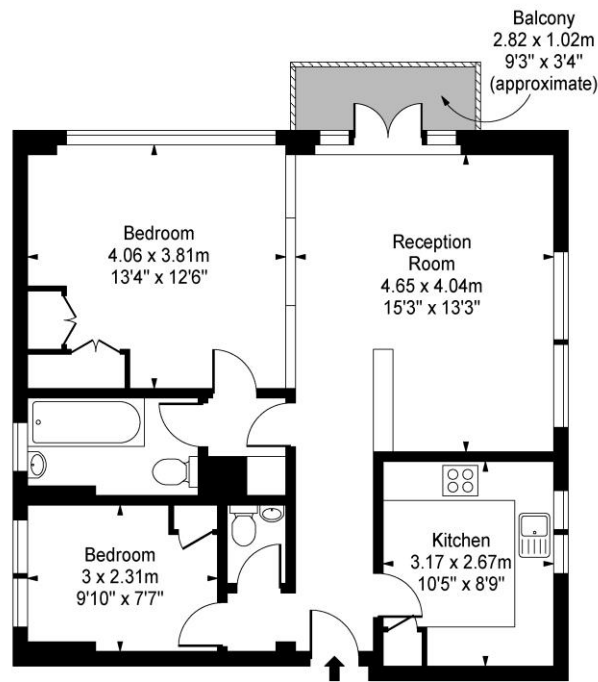

First Floor

Approx Gross Internal Area 703 Sq Ft - 65.31 Sq M

This floor plan should be used as a general outline for guidance only and does not constitute in whole or in part an offer or contract. Any intending purchaser or lessee should satisfy themselves by inspection, searches, enquiries and full survey as to the correctness of each statement. Any areas, measurements or distances quoted are approximate and should not be used to value a property or be the basis of any sale or let.

This floorplan is for illustration purposes only and is not to scale. The position and size of doors, windows, appliances and other features are approximate.

West End | 020 7240 3322 | westend@winkworth.co.uk

Winkworth

for every step...

winkworth.co.uk

Winkworth wishes to inform prospective buyers and tenants that these particulars are a guide and act as information only. All our details are given in good faith and believed to be correct at the time of printing but they don't form part of an offer or contract. No Winkworth employee has authority to make or give any representation or warranty in relation to this property. All fixtures and fittings, whether fitted or not are deemed removable by the vendor unless stated otherwise and room sizes are measured between internal wall surfaces, including furnishings.