



HIGHBURY HILL, LONDON, N5
OIEO £1,000,000 LEASEHOLD

A BEAUTIFUL TWO BEDROOM LATERAL CONVERSION
WITH COMMUNAL GARDEN SET ON ONE OF
HIGHBURYS MOST SOUGHT AFTER ROADS

Islington | 0207 354 2480 | islington@winkworth.co.uk

Winkworth

winkworth.co.uk

See things differently



DESCRIPTION:

A truly sensational, two double bedroom, two reception room period conversion positioned on one of Highbury's most popular streets, Highbury Hill. Standing close to 1,100 sqft, the property has been tastefully decorated by the current owner and offers a wealth of natural light throughout from large sash windows. Positioned at the rear of the building is a well-proportioned reception room complete with oak wood flooring and outside views of tree tops creating a complete private aspect. The kitchen and dining room are situated next to each other with the kitchen benefitting from ample worktop and storage space, while a separate wc and modern bathroom can be found at either end of the hallway. The property is completed with two genuine double bedrooms, ample storage throughout the flat, use of a secure downstairs storage room and beautifully maintained communal gardens.

The flat is set moments from the iconic clocktower at the entrance to Highbury Fields and is perfectly set for the independent shops at Highbury Barn. The high street shops, bars and restaurants on Upper Street are located via the vibrant open spaces of Highbury fields.

Transport links are some of the best around creating effortless access across London. Arsenal offers the closest underground links on the Piccadilly line whilst Highbury and Islington provides the Victoria line and overground services. The weekday service from Drayton Park goes to Moorgate and an array of bus routes are on hand which provide routes to Angel, The City and West End.

Winkworth



Winkworth

Highbury Hill, N5

Approx. Gross Internal Floor Area 1024 sq. ft / 95.13 sq. m

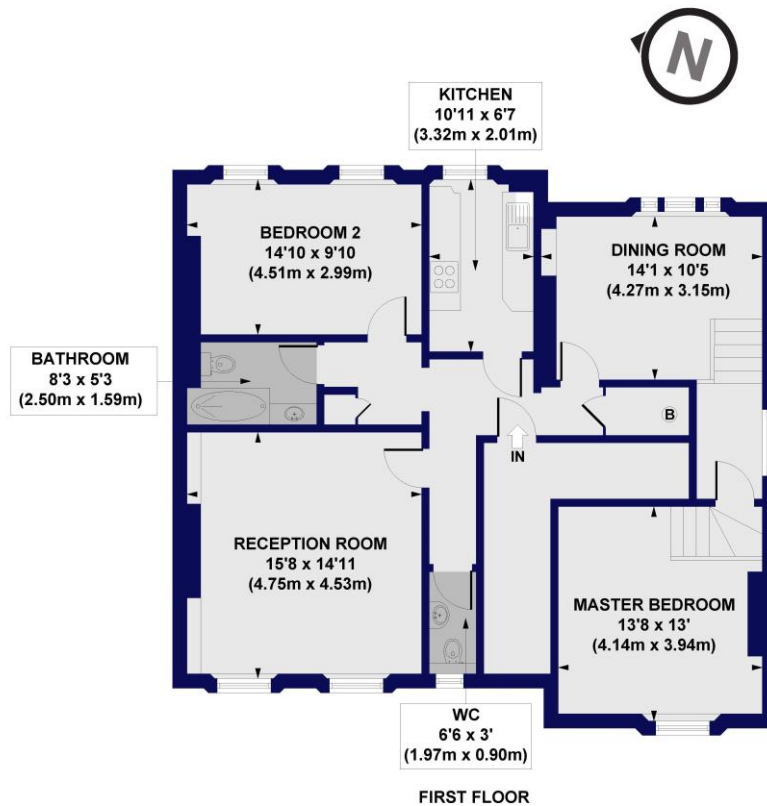

All measurements of walls, doors, windows, fittings and appliances, including their size and location, are shown as standard sizes and do not constitute any warranty or representation by the seller, their agent or CP Creative. Any intending purchaser must satisfy himself by inspection or otherwise as to the correctness of the information contained in these plans. This plan is for illustrative purposes only and should be used as such by any prospective purchasers.



This floorplan is for illustration purposes only and is not to scale. The position and size of doors, windows, appliances and other features are approximate.

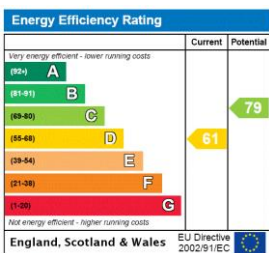

Islington | 0207 354 2480 | islington@winkworth.co.uk



winkworth.co.uk

See things differently

Winkworth wishes to inform prospective buyers and tenants that these particulars are a guide and act as information only. All our details are given in good faith and believed to be correct at the time of printing but they don't form part of an offer or contract. No Winkworth employee has authority to make or give any representation or warranty in relation to this property. All fixtures and fittings, whether fitted or not are deemed removable by the vendor unless stated otherwise and room sizes are measured between internal wall surfaces, including furnishings.